

Retail space in the heart of MIDTOWN

# 1375 BROADWAY



## SIZE

GROUND: Approx. 4,500 sf  
MEZZANINE: Approx. 2,800 sf  
BASEMENT: Approx. 3,000 sf

## RENTAL

\$65,000 per month

## FRONTAGE

Approximately 30 feet

## CEILING

Approximately 14 feet

## POSSESSION

Arranged

## COMMENTS

Located between WEST 37<sup>TH</sup> STREET and WEST 38<sup>TH</sup> STREET  
Neighbors include CITIBANK, STARBUCKS, CRUNCH, GNC, HSBC,  
MACY'S, METROCAFE, and FEDEX KINKO'S  
Food use acceptable  
Kitchen and venting in place  
Term: 15 years remaining  
No key money, commission as direct deal  
Visitors must be discreet and by appointment only  
Subways nearby: 1, 2, 3, 7, B, D, F, V, N, Q, R, S, W

## FOR FURTHER INFORMATION, PLEASE CONTACT:

Richard Du  
Chairman, CEO  
212.505.6300 x235  
rdu@dumann.com

**DUMANN** Realty, LLC

235 West 23rd Street / 5th Floor / New York NY 10011  
T 212.505.6300 / F 212.505.6444 / www.dumann.com

Procuring broker shall not be entitled to a commission even upon producing a ready, willing, and able purchaser or lessee or as the procuring cause of the transaction. Procuring broker shall only be entitled to a commission, calculated in accordance with the rates approved by our principal, when, as and if received by us and only if such procuring broker executes a brokerage agreement acceptable to us and our principal and the conditions as set forth in the brokerage agreement are fully and unconditionally satisfied. Although all information furnished regarding property for sale, rental, or financing, is from sources deemed reliable such information has not been verified and no express representation is made nor is any to be implied as to the accuracy thereof and it is submitted subject to errors, omissions, change of price, rental or other conditions, prior sale, lease or financing, or withdrawal without notice and to any special conditions imposed by our principal.

Retail space in the heart of MIDTOWN

# 1375 BROADWAY

## FLOORPLAN

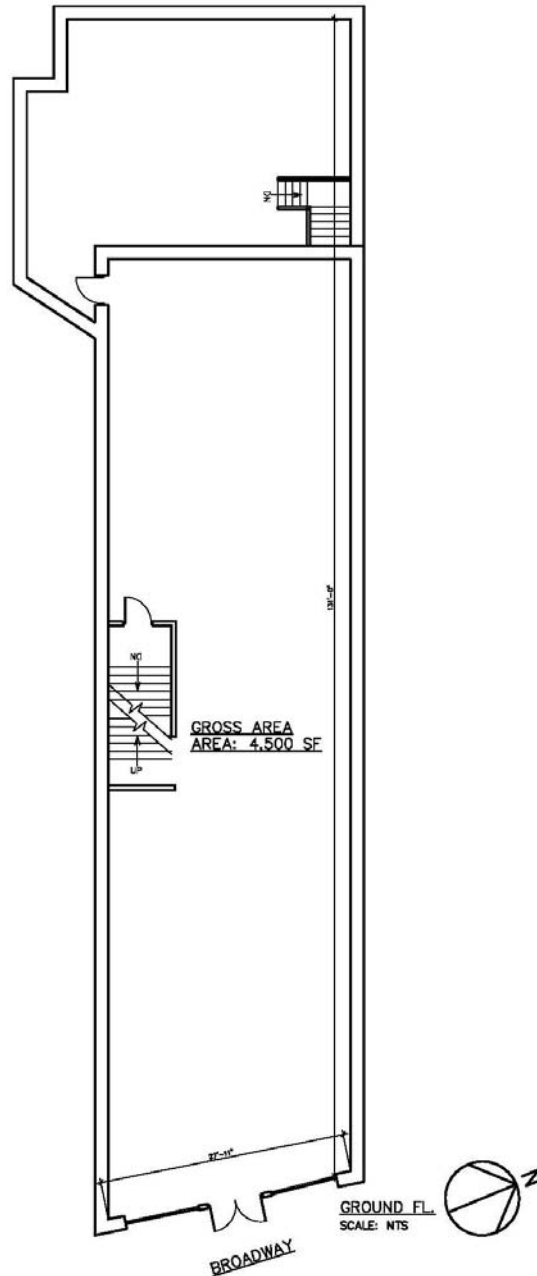

**DUMANN** Realty, LLC

235 West 23rd Street / 5th Floor / New York NY 10011  
T 212.505.6300 / F 212.505.6444 / [www.dumann.com](http://www.dumann.com)

Procuring broker shall not be entitled to a commission even upon producing a ready, willing, and able purchaser or lessee or as the procuring cause of the transaction. Procuring broker shall only be entitled to a commission, calculated in accordance with the rates approved by our principal, when, as and if received by us and only if such procuring broker executes a brokerage agreement acceptable to us and our principal and the conditions as set forth in the brokerage agreement are fully and unconditionally satisfied. Although all information furnished regarding property for sale, rental, or financing, is from sources deemed reliable such information has not been verified and no express representation is made nor is any to be implied as to the accuracy thereof and it is submitted subject to errors, omissions, change of price, rental or other conditions, prior sale, lease or financing, or withdrawal without notice and to any special conditions imposed by our principal.